

Electrical spark quenching chamber CECC 63A

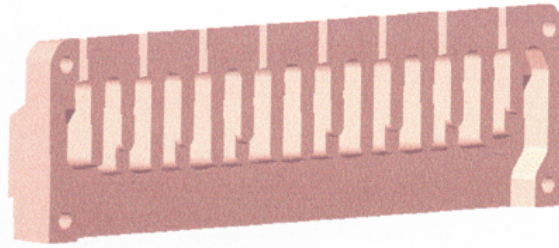

Material: zirconium ceramics CER 440

Insulation resistance: $\geq 10^{11}$ Ohms;

Thermal shock strength: 150 K;

Open porosity: 0.5%;

Sizes: 163 × 47 × 156 mm.

APPLICATIONS:

- Switching contactor
- Maximum operating current - 63 A;
- Maximum operating voltage - 1200 Vcc;

Electrical spark quenching chamber - CECC 400A

Material: zirconium ceramics CER 440.

Insulation resistance: $\geq 10^{11}$ Ohms;

Thermal shock strength: 150 K;

Open porosity: 0.5%;

Sizes: 280 × 121.5 × 10 mm.

APPLICATIONS:

Switching contactor

- Maximum operating current - 400 A;
- Maximum operating voltage - 1200 Vcc;

D.C. switch disconnecter

- Maximum operating current - 3150 A;
- Maximum operating voltage - 1000 Vcc.

